

FRESHDIRTT

DIRTT CONNEXT 2017 | CHICAGO, IL

ISSUE #411



DESIGN

Debbie Carruthers, Derek Fenske and Tori Cnudde of DIRTT Design Studio
Chris Friedlos, DIRTT
Timber Frame
Geoff Gosling and the Product Development team

ABOUT THE PROJECT

It starts with a line and leads to a one-of-a-kind space. A space made sustainably for the 21st century where technology drives the process and the result in nothing short of extraordinary. DIRTT's Chicago Green Learning Center has been rejuvenated once again to inspire our visitors and showcase the best of DIRTT at Connex 2017.

Creative innovations push the limits of convention in manufactured construction. Experience what happens when traditional craftsmanship and modern technology collide to create stunning timber frame structures. The creative genius behind DIRTT combines complex geometries and exacting precision for an inspiring display. And, DIRTT's new folding wall system with integrated technology is something you have to see to be-Leaf™.

DIRTT continues to redefine prefabrication, bringing the comfort of home anywhere – from office spaces to educational and healthcare facilities. From new wine rooms and closets to offices with a homey atmosphere, everything we build has DIRTT DNA at its core. All you need to do is imagine it.

DIRTT Connex 2017 welcomes everyone to our Chicago Green Learning Center Monday, June 12 through Wednesday, June 14. [Come say hello!](#)

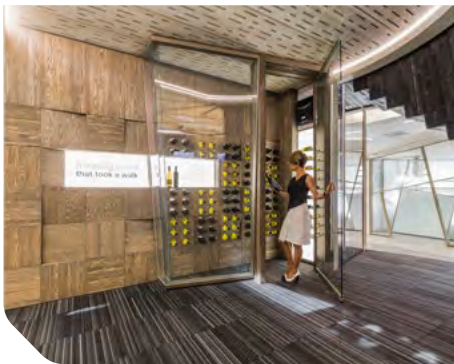

When your
inspiration connects
with technology,
everything is
built better.

DIRTT
Build better.™



SOLUTIONS

- DIRTT Timber Frame
- DIRTT Millwork
- Leaf™ Folding Wall system
- Pivot doors
- Combination, glass and solid walls

FINISHES

- Mirrored Glass
- Back Painted Glass
- Clear Tempered Glass
- Powder Coat
- Chromacoat



